

Near the district line No 1.

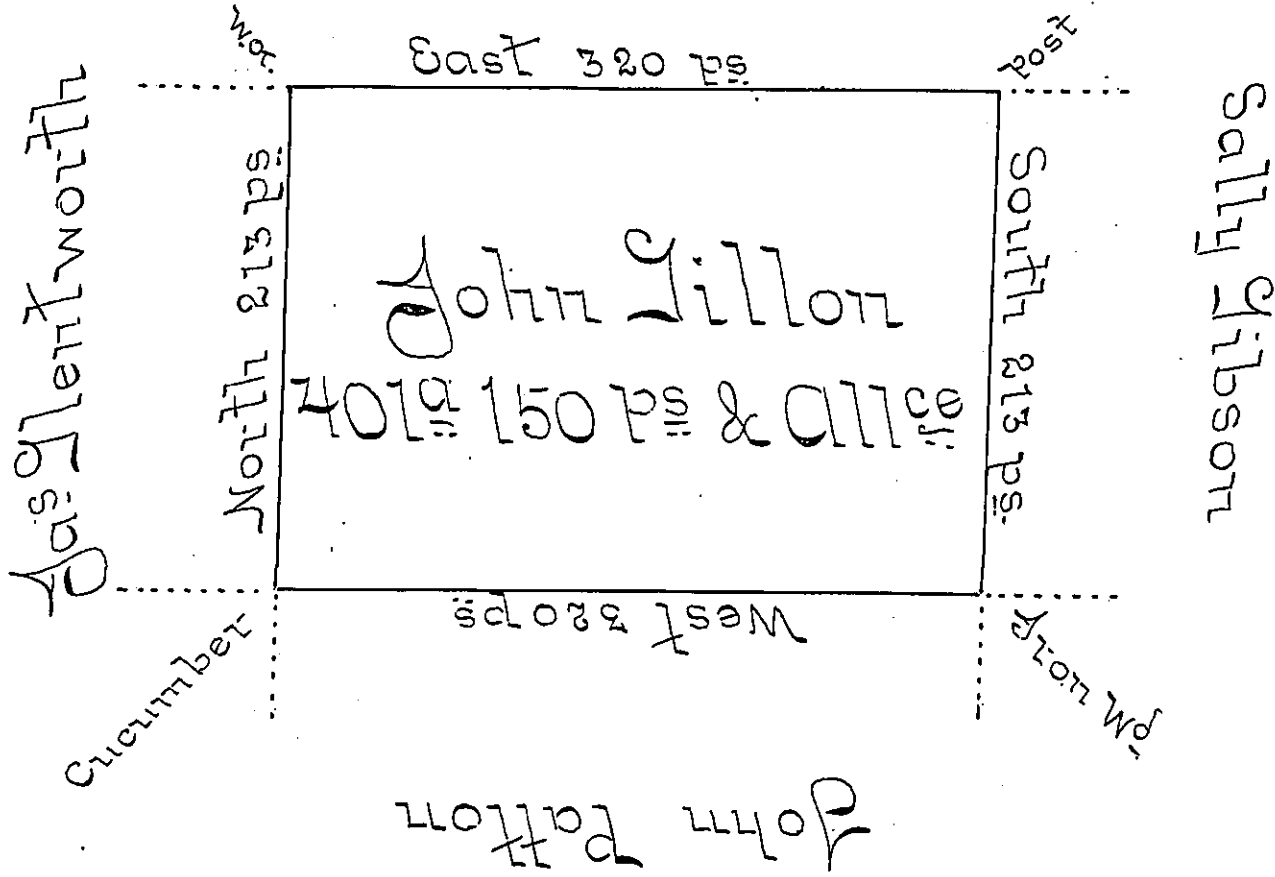

Situate on the west side of French Creek in Allegheny County containing 401 Acres and 150 ps and allowance of six 1/2 Cent for Roads &c. Surveyed the 9th day of October 1792 in pursuance of a warrant bearing date the 30th day of May 1792 ~

W^m Power D^y S^r

To Daniel Brodhead Esq^r }
 Surveyor General ~ }

IN TESTIMONY that the above is a copy of the original remaining on file in the Department of Internal Affairs of Pennsylvania, made conformably to an Act of Assembly approved the 16th day of February, 1833, I have hereunto set my Hand and caused the Seal of said Department to be affixed at Harrisburg, this Third day of October 1899.

James W. Latta
 Secretary of Internal Affairs.